



Genuine Accessories

Installation Instructions

PART NUMBER:
0000-8KN01

Cargo Area Liner

APPLICABLE MODEL:
2007> CX-9

CONTENTS:

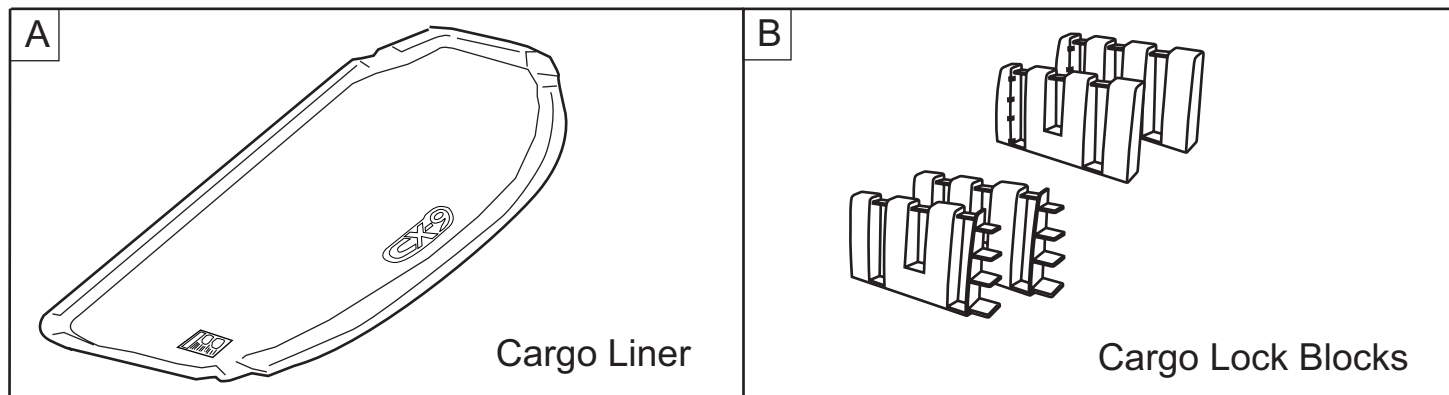

0 Before Installation

- A. It is important that the cargo area in the vehicle is not wet or damp when installing the liner, as mold or mildew may result.

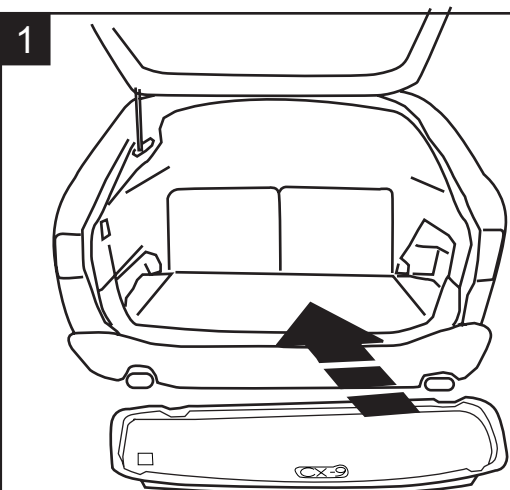

Open the rear hatch and place Cargo Liner in trunk.

2 After Installation/ Troubleshooting

- A. Liner may not lay flat upon install. It will help to lay the Liner flat in a warm area for a couple of hours before installation.
- B. Your Liner is designed to carry normal cargo. Flammable, corrosive, or dangerous/hazardous materials should not be transported in your vehicle. Non-corrosive materials spilled in your Liner can be cleaned up as described in step C.
- C. To clean your Liner, simply wash it with mild soap and water.

*Static electricity can cause an explosion of flammable material, (liquid, vapor, and gas). To reduce the risk of serious injury or death:



- Always place container on the ground before filling.
- Keep the pump nozzle in contact with the container during filling.
- Use only approved containers for flammable liquids.



Genuine Accessories

Installation Instructions

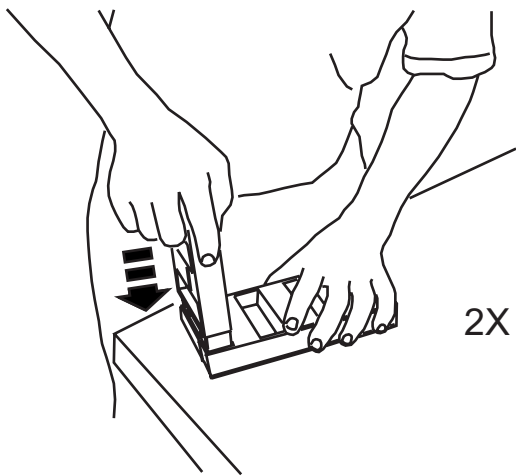
Cargo Lock Blocks

<p>1</p>  <p>Diagram 1 shows a pair of hands aligning two halves of a Cargo Lock Block. A downward arrow indicates the direction of pressure. The text "2X" indicates that this step should be repeated for two additional blocks.</p> <p>A. Align two (2) halves of Cargo Lock Blocks, as shown. B. Press halves firmly together, until edges are flush.</p>	<p>2</p>  <p>Diagram 2 shows the Cargo Lock Blocks installed in a vehicle's cargo area, used to secure a load of boxes and bottles. A curved arrow indicates the direction of potential load movement.</p> <p>Cargo Lock Blocks are designed to keep load from sliding during normal vehicle operation. Extreme operating conditions may cause loads to come loose from containment area.</p>
--	---