



GENUINE ACCESSORIES

INSTALLATION INSTRUCTIONS

PART NUMBERS:

0000 8R D20 (CHROME FINISH)-SOFT TOP
0000 8R D26A (CHROME FINISH)-RETRACTIBLE TOP

Fuel Door

APPLICABLE MODELS:

2005>MX-5

PACKAGE CONTENTS

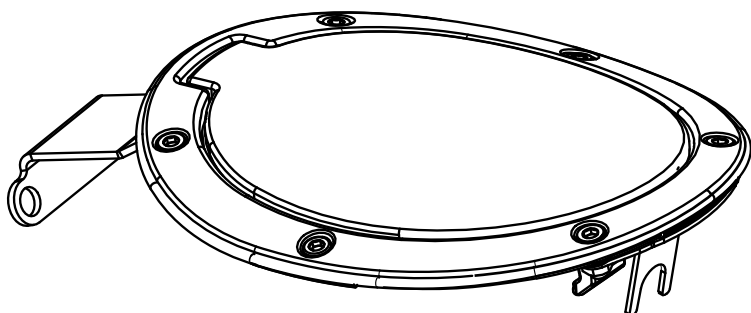

FUEL DOOR ASSEMBLY
WITH O-RING
(QTY. 1)

TOOLS REQUIRED

Note: All Tools are 1/4" drive

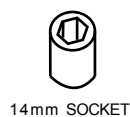

14mm SOCKET

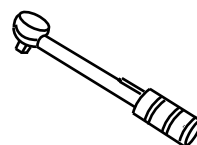

TORQUE WRENCH

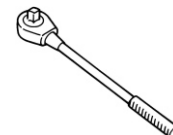

SOCKET WRENCH



8mm SOCKET

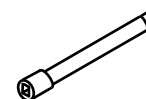

SOCKET EXTENSION



SOFT TOWEL



SOAP & WATER
SOLUTION

0

BEFORE INSTALLATION

1. READ ENTIRE INSTRUCTIONS BEFORE PROCEEDING.
2. BE CAREFUL NOT TO SCRATCH THE CAR'S PAINT WHILE INSTALLING THE FUEL DOOR.
3. MAKE SURE TO KEEP THE FUEL CAP ON DURING THE INSTALLATION PROCESS

1

REMOVAL OF OEM FUEL DOOR

1. Open OEM fuel door, keeping fuel cap on to prevent the bolts from falling down the fuel pipe.
2. Use an 8mm socket with extension and socket wrench to remove bolts holding fuel door. (SAVE BOLTS FOR REASSEMBLY)
3. Remove OEM fuel door assembly
4. Remove fuel cap.
5. Remove tether from OEM fuel door by grasping head of tether and pulling outward.
6. Reinstall fuel cap.

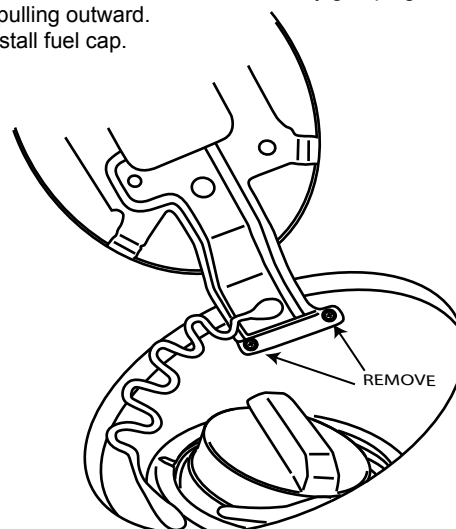

2 REMOVING THE OEM FUEL DOOR SPRING

CAUTION: FUEL DOOR LOCK PLUNGER MAY SLIP INSIDE THE VEHICLE BODY IF CARE IS NOT TAKEN IN THESE STEPS

1. Use a 14mm socket and socket wrench to remove the nut holding the fuel door lock plunger.
2. Remove the spring clip and retain with the OEM fuel door.
3. Lightly thread the nut back on the plunger leaving a gap for the small bracket to slide between the nut and wall of the car.
4. Retain spring clip with OEM door.

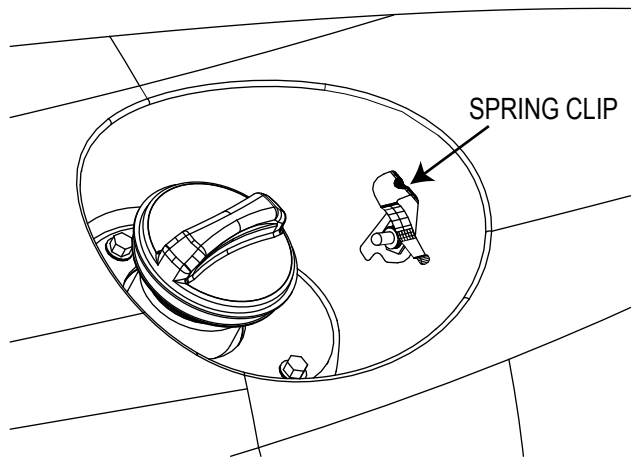

3 ATTACHMENT OF TETHER

1. Take tether and insert into hole in large bracket making sure that the tether head seats fully onto the bracket.

NOTE: MAKE SURE TETHER IS NOT TWISTED.

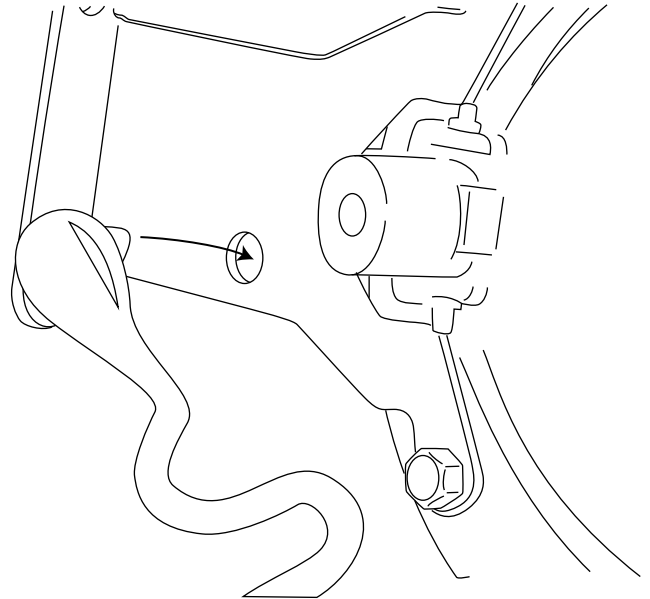

4 INSTALLATION OF FUEL DOOR

1. Check O-ring to ensure that it is seated properly on the fuel door ring.
2. Guide large bracket through opening.
3. Slowly rotate the fuel door until the fork of the small bracket can slide between sheet metal and plunger nut.
4. Make sure that the tether is not pinched between the fuel door and the body.

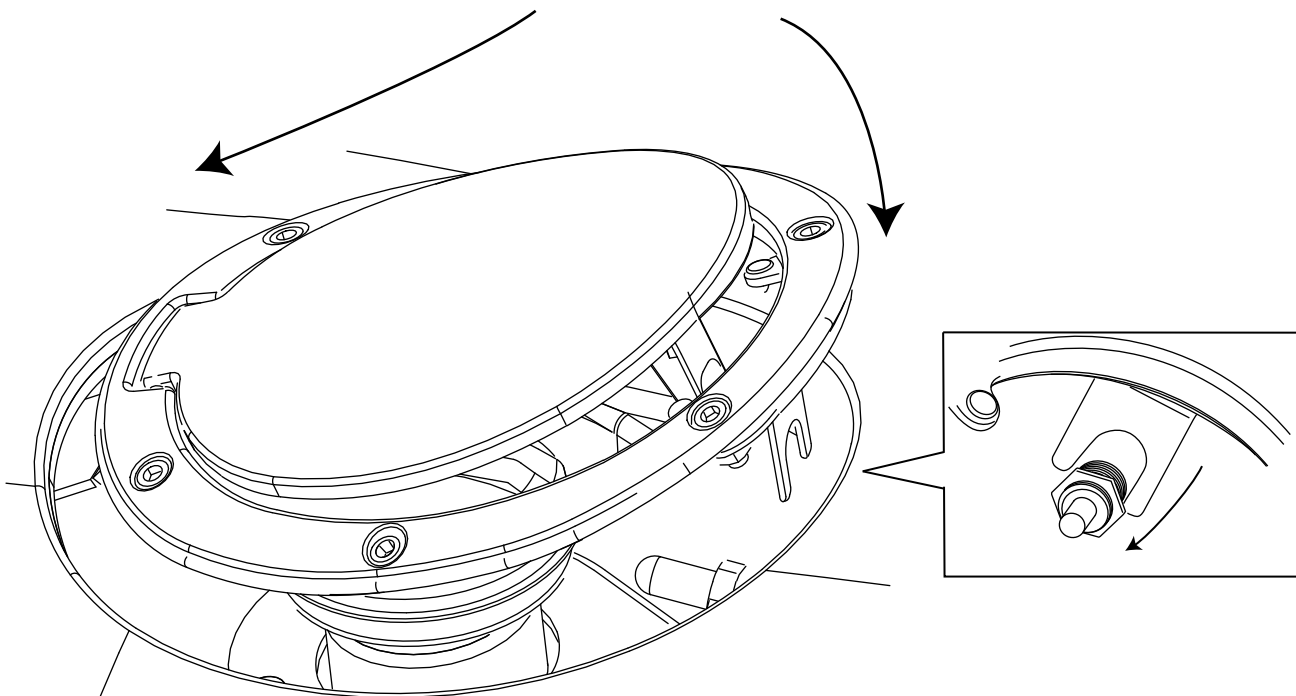

5**ALIGNMENT OF THE FUEL DOOR
STEP ONE**

1. With fuel door open (filling position), hand tighten the plunger nut while still allowing the fuel door assembly to rotate.
2. Align holes of large bracket with original OEM fuel door mounting holes.
3. Use the 8mm socket and socket extension to insert the bolts into the holes and hand tighten allowing the fuel door assembly to move.

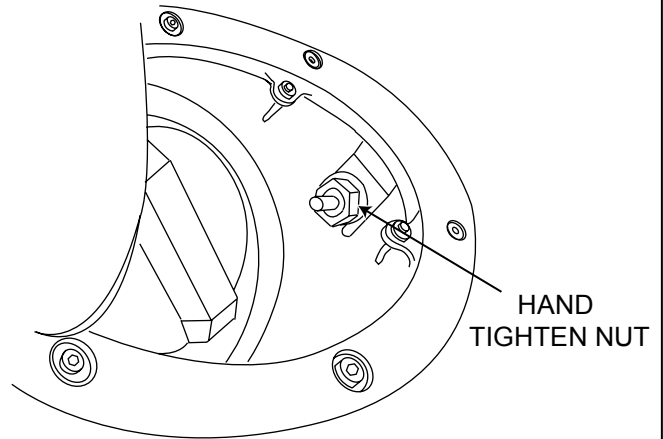
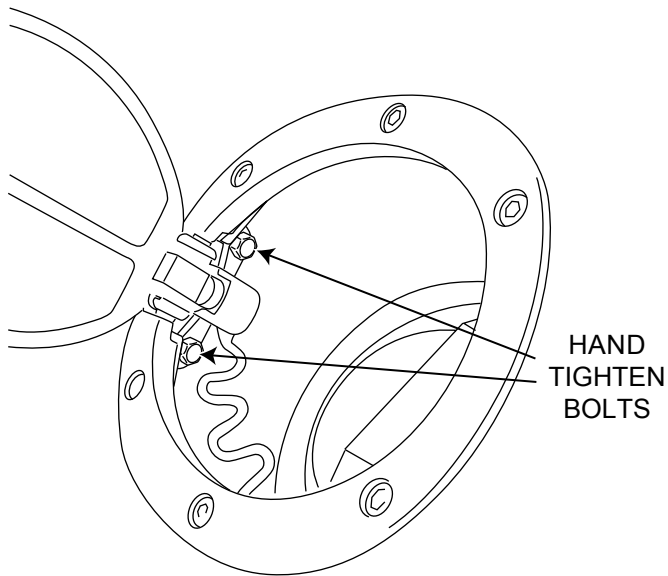
**6****ALIGNMENT OF THE FUEL DOOR
STEP TWO**

1. Align the fuel door's surface with the vehicle's sheet metal.
 - a. Make sure fuel door is flush with vehicle's sheet metal, top to bottom and front to back.
 - b. The gap around the fuel door and sheet metal opening should be equal all the way around.
2. Torque the 14mm nut that secures the lock plunger to 4.0 N-m (35 in-lbs.).
3. Torque the bolts that hold the front bracket to 5.1 N-m (45 in-lbs).

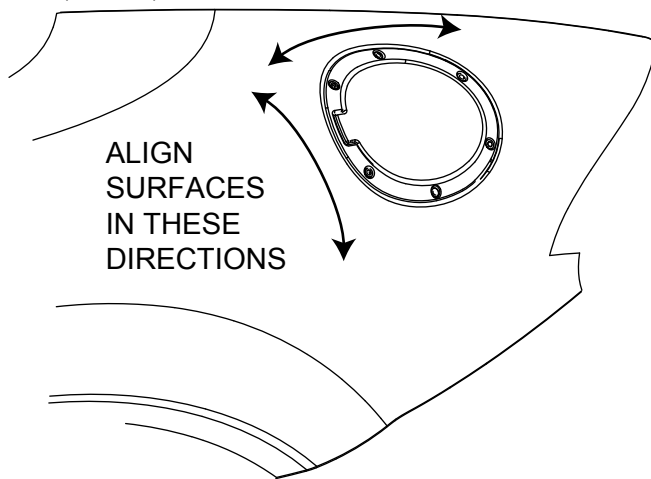

NOTE: THE DOOR CAN ROTATE SOME AT THIS POINT, SO TRY TO KEEP THE FUEL DOOR SURFACE ALIGNED WITH THE CAR'S SHEET METAL WHILE TIGHTENING THE BOLTS

7**FINAL INSPECTION AND
CLEANING**

1. Firmly grasp the fuel door's ring to make sure the assembly is securely fastened to the car.
2. Check for proper function of:
 - a. Fuel door lock release
 - b. Opening and closing of fuel door
3. Use a soap and water solution with a soft cloth to wipe any fingerprints and grease away from the fuel door and car's paint.
4. Return OEM door, spring clip and installation instructions to customer.